

Solar Power Module: 170W

Features

- 72 x 125mm square, mono-crystalline high efficiency silicon cells.
- Lightweight and rigid anodised aluminium frame.
- High transmittance & impact resistant tempered solar grade glass.
- Advanced EVA encapsulated multi layer backsheet.
- Dark blue silicon nitride anti-reflection film on cells.
- Multi Contact quick-connect junction box/output leads.
- 25 yr power output & 10 yr product defects warranty.
- Design qualified to IEC international standards.

Applications

- On/off grid power stations
- Telecommunications
- Remote power systems
- Stand alone or grid connected applications

Materials

- 125mm x 125mm mono-silicon cell type
- 72 cells in cell circuit
- 3.2mm front solar glass for added strength
- EVA film encapsulation
- Junction box with 3 bypass diodes fitted
- Quick connect 2 x 900mm output cables
- Compact size of 1580mm x 808mm x 35mm
- Net solar module weight of 15kg

Working Environment

- Temperature range of -40⁰C ~ 60⁰C
- Wind Pressure of < 3,000 Pa
- Snow Pressure of < 2,000 Pa

Warranty

- 25 years on output power
- 10 years on materials and workmanship

International Accreditation

- ISO9001:2000 certified manufacturing facility.
- TÜV Safety Class II Test.
- Certified to IEC 61215, IEC 61730
- Safety rated to UL 1703.

Our solar module range is designed and built to deliver the highest efficiency and reliable power for on-grid residential and commercial systems worldwide.

The solar module features superior power conversion efficiency of up to 14.5% and exceptional low light performance and uniform appearance.

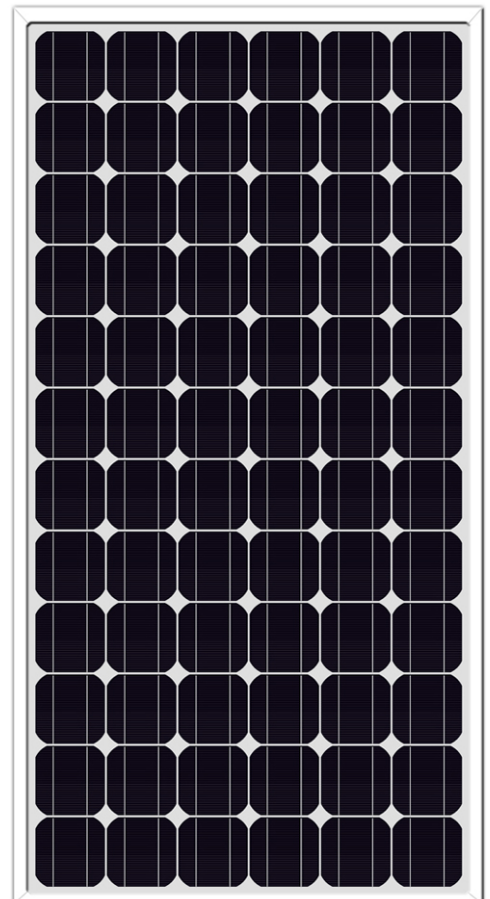

Specifications

Electrical

| | |
|-----------------------------|------------|
| Maximum Power | 170 W |
| Tolerance | +/- 3% |
| Open Circuit Voltage (Voc) | 43.3 V |
| Short Circuit Current (Isc) | 5.0 A |
| Max. Power Voltage (Vm) | 36.1 V |
| Max. Power Current (Im) | 4.71 A |
| Temp. Coefficient of Isc | 0.065% |
| Temp. Coefficient of Im | +0.1/°C |
| Temp. Coefficient of Voc | -2.23mv/°C |
| Temp. Coefficient of Vm | -0.38/°C |
| Temp. Coefficient of Pm | -0.5%/°C |
| Module Efficiency | > 14.4% |
| Max. System Voltage | 1,000VDC |

Environment

| | |
|-----------------------|----------------------|
| Temp. Range | -40°C ~ +85°C |
| Surface Load Capacity | 200kg/m ² |

Mechanical

| | |
|------------------------|------------------|
| Cell Type | Mono Crystalline |
| Cell Size | 125mm x 125mm |
| Cell Wiring | 72 series |
| Low Iron Solar Glass | 3.2mm |
| Encapsulation | EVA Film |
| Junction Box | Cixi Renhe |
| Output Power Cable | 2 x 900mm |
| Module Dimensions (mm) | 1580 x 808 x 35 |
| Module Weight | 15 |

Warranty

| | |
|------------------------|----------|
| Material & Workmanship | 10 years |
|------------------------|----------|

Power Output

| |
|----------------|
| 25 years ~ 80% |
| 12 years ~ 90% |

Electrical Performance at 25°C, AM1.5

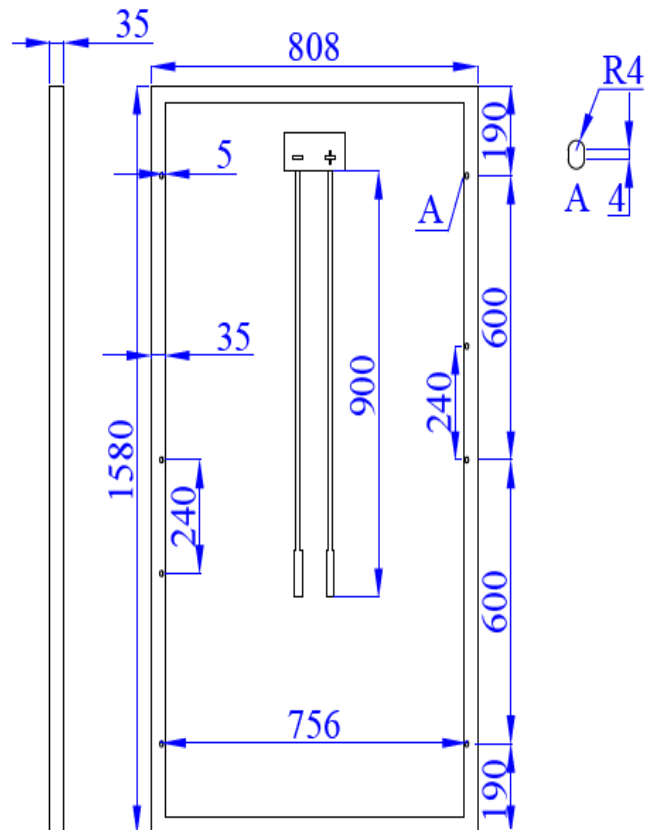
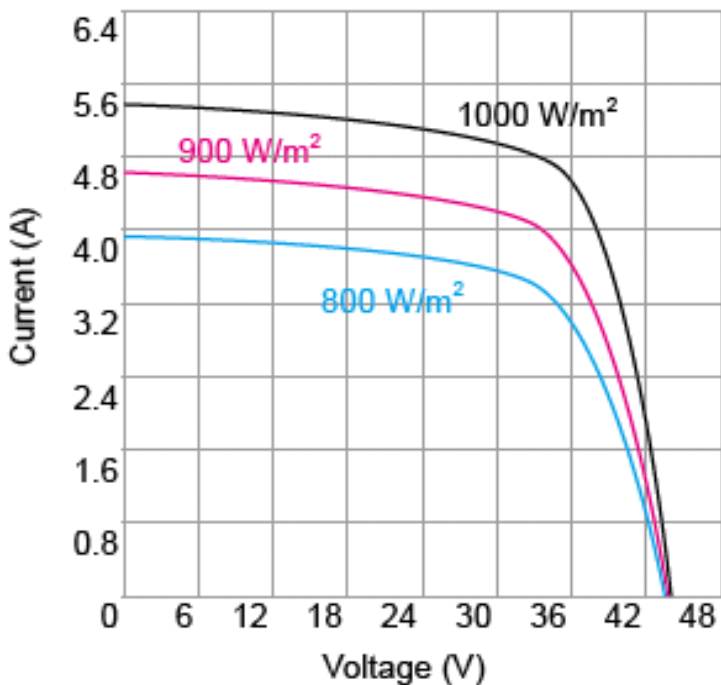

© Environmental Power Solutions Pty Ltd 2009
 Unit 2/443 Great Eastern Hwy
 REDCLIFFE WA 6104
 T: (08) 9477 4570
 F: (08) 9477 6141
 E: admin@epswa.com.au

